

## CONTENTS

Strong seal cap



Y-cut Teat



Sealing Ring



Swirler



Inner Chamber

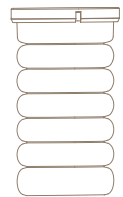

Outer Casing



Bottle Base



Teat punch



## FIRST USE INSTRUCTIONS

You have just opened the packaging and want to start using the Silbottle.

1. Check all parts are included and undamaged.
2. Disassemble the bottle, removing the cap first.
3. Due to the high quality and soft nature of the teat the Y-cut hole can re-seal over time. If necessary use the Teat Punch to re-open by pressing gently on the hole from inside the teat.

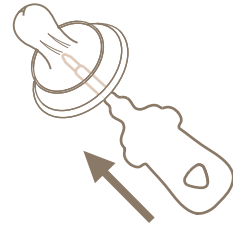

The Silbottle is now ready for **Daily Use** preparation  
**There is no need to repeat these steps again**

### INTRODUCING THE INNER CHAMBER

Q: How do you measure the quantity of milk in the bottle?

A: Each rib on the Silbottle Inner chamber equals 1 fl oz or 30ml

Q: Can I pour boiling water into the inner chamber?

A: YES. The inner is made of high quality silicone and can withstand high temperatures.

Q: Do I have to sterilise the outer casing and the Inner Chamber?

A: The outer casing should be washed in soapy water before each use. However the outer casing never touches the milk so only the Inner Chamber and Teat have to be sterilised.

Q: Can I microwave the bottle and Inner chamber?

A: YES. The entire bottle including the Inner Chamber can withstand high temperatures.

Q: Can I sterilise the Inner Chamber

A: Yes, with either a microwave or electric steriliser.

Q: Can I re-use the Inner Chamber?

A: Yes.

Q: Can I freeze the Inner Chamber?

A: Yes.

1oz

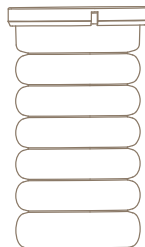

## DAILY USE INSTRUCTIONS

Before using the Silbottle ensure your hands and surfaces are clean. Follow the instructions on cleaning and sterilisation.

①



### INSERT INNER CHAMBER

Once sterilised we recommend the use of tongs to drop the Inner Chamber into the Outer Casing.

②

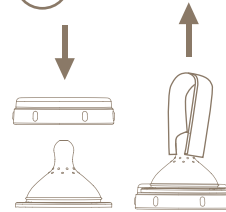

### ASSEMBLE TEAT

Place the Sealing Ring over the teat and pull the Y-cut Teat through into the Sealing Ring.

③

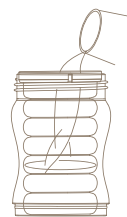

### FILL INNER CHAMBER

Follow packet instructions for powdered milk. Carefully pour desired amount of milk into the Inner Chamber. Each rib of the Inner Chamber contains 30ml (1oz) of milk.

④



### INSERT SWIRLER FOR POWDERED MILK ONLY

If using powdered milk use tongs to place Swirler into Inner Chamber with **blades downwards**. The Swirler prevents lumps of undissolved milk powder blocking the Y-cut Teat.

⑤

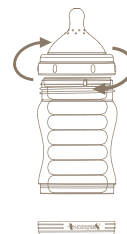

### ASSEMBLE BOTTLE

Screw on Sealing Ring, ensuring it is tightly sealed. If the milk is at the correct temperature attach the Bottle Base. Alternatively refer to the Warming instructions. Always test the temperature of the milk before feeding.

## CLEANING

Before and after each use hand wash all the parts thoroughly and leave to dry on drying rack. The Inner Chamber can be turned inside out for thorough cleaning. The following parts should be sterilised for use. The Silicone teat, sealing ring, swirler, strong seal cap and Inner Chamber. The Inner Chamber has been designed to withstand the high temperatures for sterilising.

## WARMING

Milk can be warmed in the Silbottle. Follow the Daily use Instructions ensure the Teat and Sealing Ring. Before attaching the Bottle Base place the bottle in a bowl of warm water. The wide base of the Silbottle should allow it to stand in the water easily. Test the milk during warming and complete step 5 before feeding.

## FEEDING

The elegant hour glass design makes it comfortable to hold from either base, centre or top. This allows the baby to be cradled in a similar position to breastfeeding by either mum or dad.

## AFTER FEEDING

1. If there is any milk left in the bottle carefully unscrew the lid and allow the inner chamber to re-expand. This allows you to note how much milk is unfinished. Each rib is 1oz.
2. Remove the Inner Chamber from the casing and empty it into the basin. Pull the inner at either end to allow the last remaining milk to flow out.
3. Rinse the Inner Chamber under the tap or turn it inside out to wipe with a cloth. Then place on the drying rack.

## STORAGE

The Silbottle can be used as a Bisphenol-A free storage container in fridges or freezers. The teat can also be removed and replaced with a Silbottle Lid Insert™ (available separately).